

| REV: | DATE:    | AMENDMENTS: | DRAWN: | CHECKED: |
|------|----------|-------------|--------|----------|
| #    | XX.XX.XX |             | XX     | XX       |

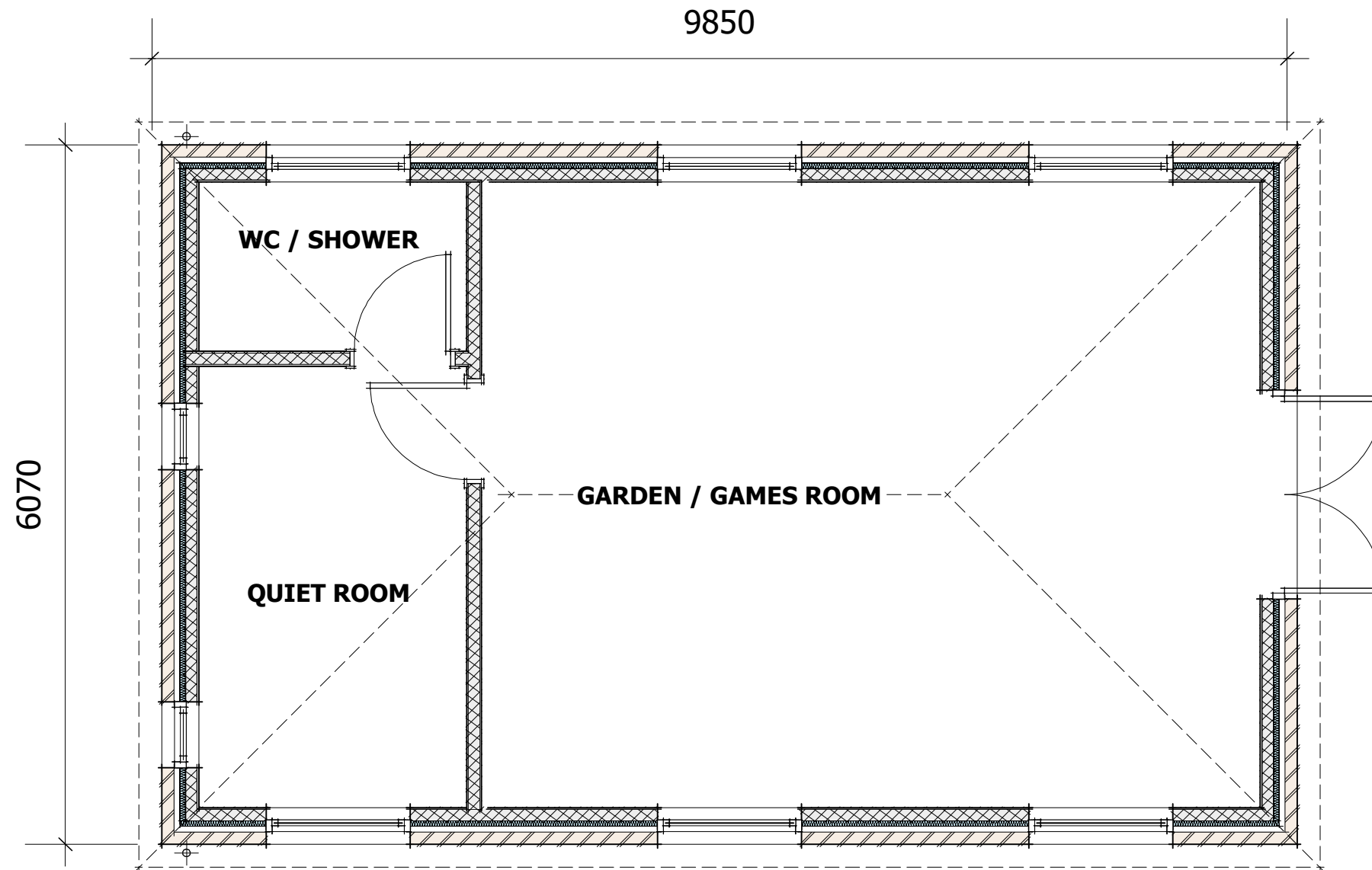

**PROPOSED FLOOR PLAN - Scale 1:50**

CLIENT:  
**Mr & Mrs Shinkwin**

PROJECT:  
**Grimms Dyke**

DRAWING:  
**Proposed Floor Plan**

SCALE: **1:50 @ A3** DWG NO: **2011/P03**

DATE: **April '16** REV: **#**

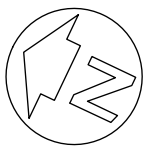

● Grosvenor Court, Winchester Road, Ampfield, Winchester, Hants. SO51 9BD  
Tel: 01794 368 698  
○ 2 Old Bath Road, Newbury, Berks. RG14 1QL  
Tel: 01635 40184